

PORTABLE SCREW COMPRESSOR

PDS185S



Main Improvements:

- ◆ Superior Serviceability
 - Newly-designed GULL-WING door - Easiest access to interior inspection and maintenance
 - Filter Cartridge type Separator allows Easiest replacement
- ◆ Main Components - Maintenance-Free
 - New Piston type Automatic-Relief Valve has no diaphragm. Thus servicing of diaphragm is not required any longer.
 - Pressure Adjustment Regulator has become smaller and has no diaphragm which need be replaced. It is not necessary to replace diaphragm any longer.
- ◆ Smooth and Easy Cleaning
 - Fittings of oil piping connection have been designed to be O-Ring seat type to eliminate oil leakage.
 - Radiator and oil cooler are combined in form of one piece panel so that it provides much more smooth and easier cleaning of radiator and oil cooler.



OUR BOTH PLANTS ARE CERTIFIED RECOGNIZED AS BEING WORTHY OF ISO 9001 CERTIFICATION.

HOKUETSU INDUSTRIES CO., LTD.

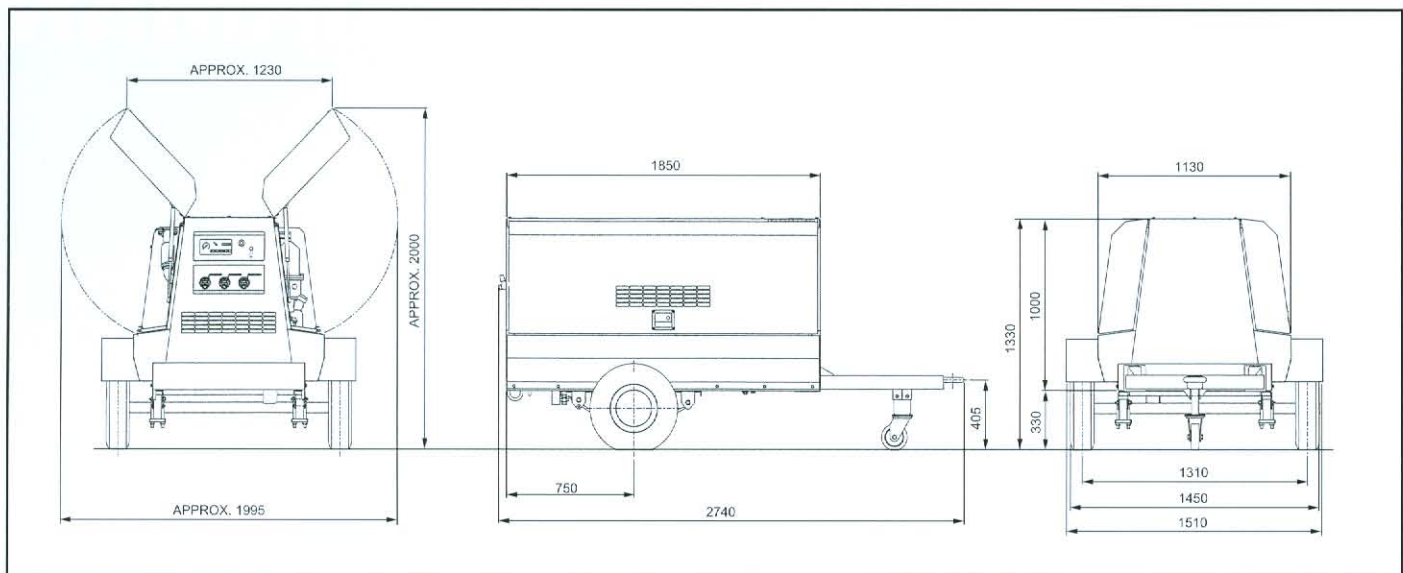

SPECIFICATIONS

COMPRESSOR

Type	Rotary twin screw, single stage, oil-cooled
Free air delivery	5.0 m ³ /min (175 cfm)
Working pressure	7.14 kgf/cm ² G (0.7MPa) (100 psi)
Unloader	Suction port closing in connection with stepless speed regulator
Lubrication system	Forced lubrication by compression pressure
Driving system	Direct coupling with engine through gears
Oil cooling	Air-cooled
Air cleaner	Dry paper filter type

DIESEL ENGINE

Model	Isuzu 4LE2
Type	Water-cooled, 4-cycle, direct injection type
No. of cylinders	4
Cyl. bore X stroke	85 mm X 96 mm
Total displacement	2.179 cc (2.179 liters)
Compression ratio	18.8 : 1
Rated output	51.5 PS/3,000 rpm (37.9 kW/3,000 min ⁻¹)
Max. torque	14 kgf.m / approx. 2,000 rpm (137 Nm / approx. 2,000 min ⁻¹)
Injection pump	Bosch type
Governor	Centrifugal, all-speed
Alternator	DC 12 V, 20 A
Starting motor	DC 12 V, 2.0 kW
Battery	80D26R-MF (NX110-5MF) X1 pc.
Air cleaner	Dry type
Fuel tank capacity	90 liters
Engine oil capacity (including oil cooler)	8.5 liters
Coolant capacity (including engine radiator)	7 liters
Compressor oil capacity (including receiver tank & oil cooler)	16 liters

OIL SEPARATOR-RECEIVER TANK

Type	Vertical, cylindrical, full-welded
Shell dia.	φ 220 mm
Shell length	757 mm
Capacity	0.03 m ³
Max. working pressure	10.2 kgf/cm ² G (1.0 MPa)
Hydraulic test pressure	15.3 kgf/cm ² G (1.5 MPa)
Air outlet valve	20 A X 3 pcs.

INSTRUMENTS & GAUGES

EMERGENCY STOP DEVICES

- Oil pressure switch
- Engine coolant temperature switch
- Discharge air temperature switch

GAUGES

- Pressure gauge
- Houemeter
- Fuel gauge
- Starter switch
- Starting unloader valve

WARNING LAMP

- For engine oil pressure drop
- For engine coolant temperature rise
- For discharge air temperature rise
- For battery charging
- For preheating

WEIGHT

Dry weight	805 kgs
Operating weight	915 kgs

HOKUETSU INDUSTRIES CO., LTD.

12th Floor Shinjuku San-Ei Bldg.,
22-2 Nishi-Shinjuku 1-Chome, Shinjuku-ku, Tokyo 160-0023 Japan
Tel: Tokyo 03(3348)7281 Fax: Tokyo 03(3348)7289
e-mail: info@airman.co.jp
URL: http://www.airman.co.jp

HOKUETSU INDUSTRIES EUROPE B.V.

Rivierstaete, Amsteldijk 166-1079LH Amsterdam The Netherlands
Tel: 020-6462636 Fax: 020-6462191
e-mail: hokuetsu@euronet.nl

SAFETY

- Operate safely in accordance with proper operation manual.
- To prevent trouble and accidents, perform daily and preventive maintenance checks without fail.

ISO9001



JQA-0581